

## PLAN DRAWING

Complete a simple line drawing of the premises and identify your fire safety provisions including escape routes, portable fire extinguishers, smoke and / or heat detectors, emergency lighting and fire alarm call points.

### KEY

Escape Routes →

Fire Extinguishers ▲

Smoke Detectors ○ SD

Heat Detectors ○ HD

Fire Alarm Sounders 

Emergency Lighting **EL**

Manual Break Glass Point **MBGP**

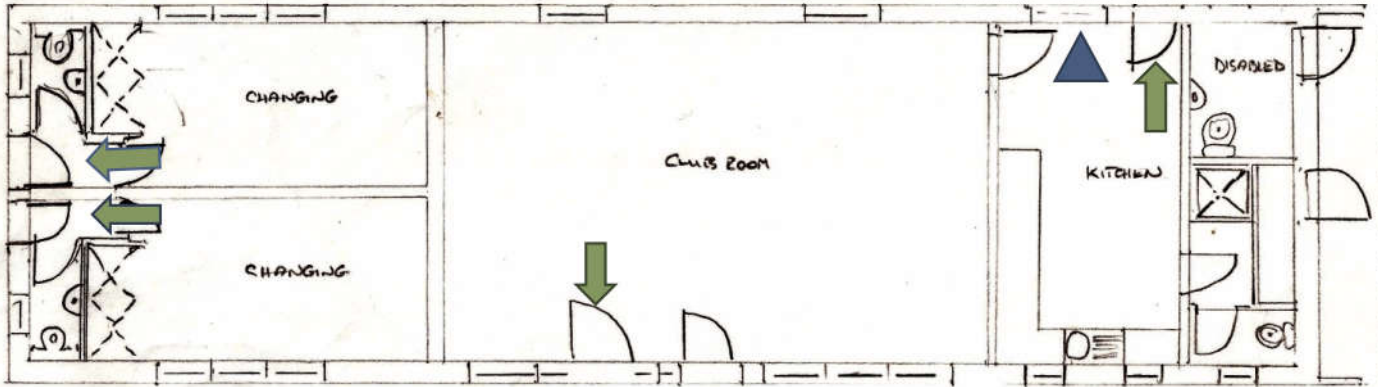

In case of fire:

1. Shout, "Fire, Fire, Fire"
2. Leave the building by one of the identified exit points. Do not stop to collect personal belongings
3. If you can tackle the fire using a fire extinguisher without putting yourself or others at risk – do so, and then leave the premises.
4. Assemble outside the building at the designated Fire Assembly Point – by the tennis courts.
5. Dial 999 and ask for Fire and Rescue service the address is: The Pavilion, King George the Fifth Field, Framwellgate Moor, DH1 5BL. The Nearest public call box is outside the Marquis of Granby pub.
6. Do not re-enter the building until it is made safe and you have been told that you can do so.

## Identifying Ignition and Fuel Sources

As an aid to identifying the hazards within your premises it's possible to use a system of noughts and crosses, using an **X** to mark **ignition sources** and an **O** for **fuel sources**.